



URBANFINITY

CONTEXT MAP

PRODUCT DESCRIPTION | 2021

Urbanfinity Pty Ltd

Context Map - 11-44 George Street, Hornsby NSW

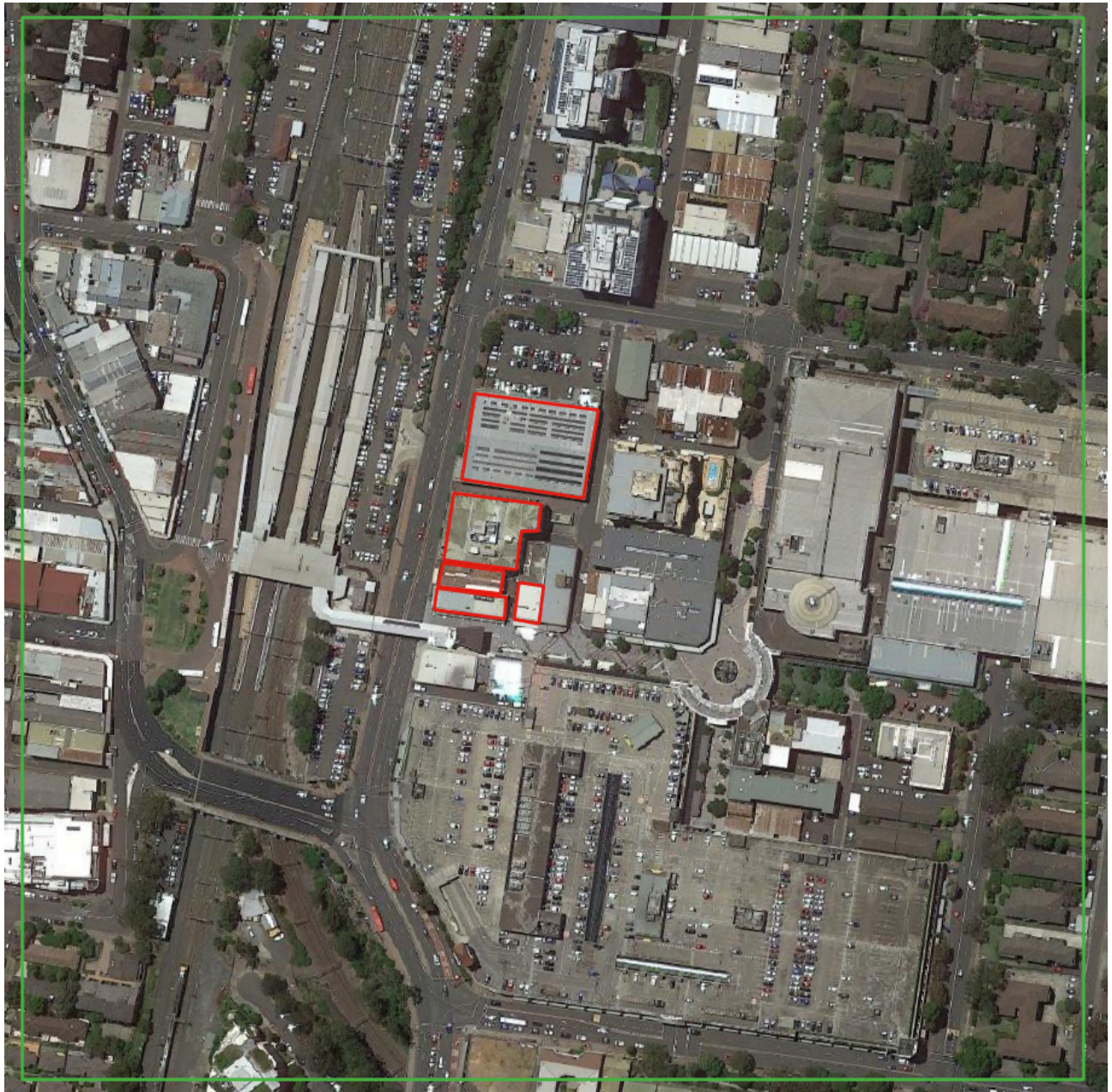

Project Scope: 500m x 500m



QUOTATION

From **URBANFINITY PTY LTD**
 Suite 5.04 L5, 161 Gloucester St,
 The Rocks NSW 2000
 www.urbanfinity.com.au
 Ph: 02 9262 4458
 ABN: 97619495135
 ACN: 619495135

Estimate For **Charter Hall**
 Shaun Klein
 Investment Analyst
 +61 2 8651 9590 | +61 423 555 312 |
 shaun.klein@charterhall.com.au |
 charterhall.com.au

Estimate ID **215220**
 HRN Number C-000900-JB
 Issue Date 27/04/2021

Subject 500m Context Map Pro - 11-44 George Street, Hornsby NSW

Item Type	Description	Quantity	Unit Price	Amount
Service	Context Map Pro CAD format: Revit 2021 Area: 500m x 500m Context Map features included: <ul style="list-style-type: none"> • 2D/3D Context Map - native file format • Building Structures, Elevation and Position • Cadastral boundaries • Terrain Data • Road Representation • Tree Model • Interactive HTML File • Plus Original Nearmap 2D/3D Data Nearmap 2D - Capture Date: Apr 2021 Nearmap 3D - Capture Date: Feb 2020 *50% discount for first time company supply has been supplied.	1.00	\$1,500.00	\$1,500.00

Subtotal	\$1,500.00
GST (10%)	\$150.00
Estimate Total	\$1,650.00

ABOUT OUR COMPANY

At Urbanfinity we are a team of innovation driven architects and data scientists who passionately believe that everyone should have easy access to the latest geospatial technology and data. We do this by working together with multiple geospatial data providers and CAD platforms to transform all project site specific information into one CAD Contextual model package. Our Context Map is tailored to the need of design professionals such as Architects and Urban Planners to jumpstart their design process with a suite of geospatial CAD data and analytics.

We believe in order to achieve the best possible solutions for our clients we must empower modern professionals with easy to use CAD workflows that integrate to their CAD platform of choice to deliver information-driven designs for sustainable optimised developments across Australia.



JAMIE BONNEFIN
Director & Entrepreneur



DR SEBASTIAN HAAN
Director & Research

W E L C O M E T O
URBANFINITY

INTRODUCING CONTEXT MAP

Launched in 2019, **Context Map** is a revolutionary new tool for design professionals to jumpstart their project work with a suite of geospatial data - providing all contextual layers as 3D models for your project site in your favourite CAD format.

Our next generation **Context Map** transforms high-resolution aerial and LiDAR 3D data rapidly into accurate and regular updated 3D models. This allows a much higher level of details for buildings structures and site accuracy.

Context Maps is natively supported and fully compatible with all major CAD platforms, making it easier for Architects and Planners to adapt to the Context Map technology which in turns speeds up their design and planning process.

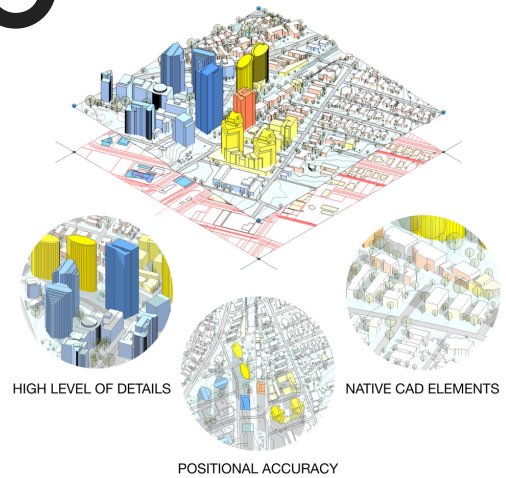

KEY FEATURES

- Detailed 3D building structures
- Property layouts and titles
- Terrain and topography
- Trees and vegetation
- 3D native native CAD formats
- Current and Contextual
- Real World 3D Features

** Context Map is not a legal survey and there are no licensed surveyors responsible for the creation of Context Map contextual models. We recommend obtaining a legal survey from a professional for every project.



SUPPORTED BY



Australian Government
**Department of Industry,
Innovation and Science**

Business Entrepreneur's Programme

Supported by Australian Government through Accelerating Commercialisation, an element of the Entrepreneurs' Programme

PARTNERS

**OUR DATA
PARTNER
NETWORK**



HOW IT WORKS



SITE SELECTION

Select site address and extent (from 250m x 250m to 1km x 1km tiles), or provide custom shape (available on contextmap.com.au)

DATA FUSION

Context Map Pipeline: geospatial processing of satellite + Nearmap 2D/3D + ground measurements

MODELING

3D modeling and parametrisation, CAD processing, and multiple QA checks verify all features are accurate

DELIVERY

Download CAD Model Package. Delivery typically within 1-2 business days (depending on size)

SUPPORTED CAD FORMATS

AUTOCAD

VECTORWORKS

RHINO 3D

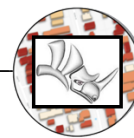
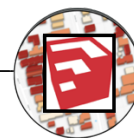
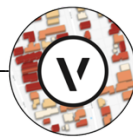
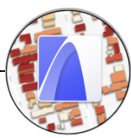

REVIT

ARCHICAD

SKETCHUP



FEATURES

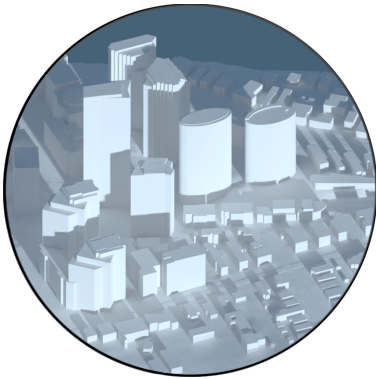

BUILDINGS

Footprints
Heights ()
Multi-Level Structure

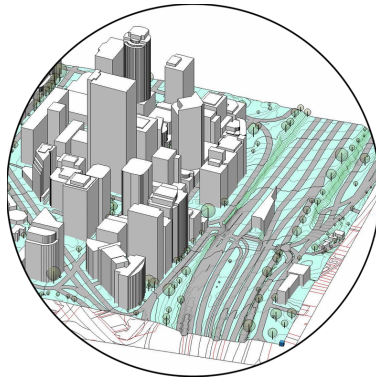

TERRAIN & TOPOGRAPGY

3D Terrain Model
Roads
Hydro

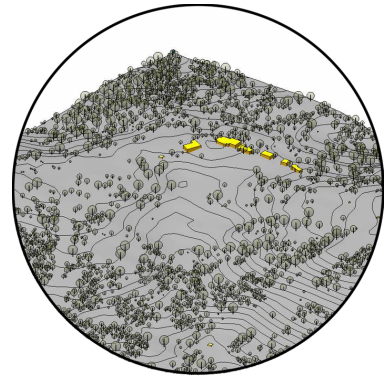

VEGETATION

Tree Models
Tree Positions
Tree Heights



3D GEOREFERENCED

Nearmap 3D Height
VerificationPositional
VerificationGeoreferences



CADASTRAL

Property boundaries
Measurements
Lot Titles

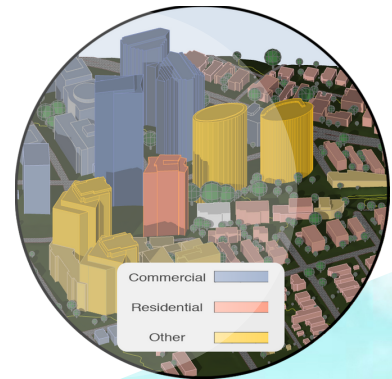

ZONING

Commercial
Residential
Industry

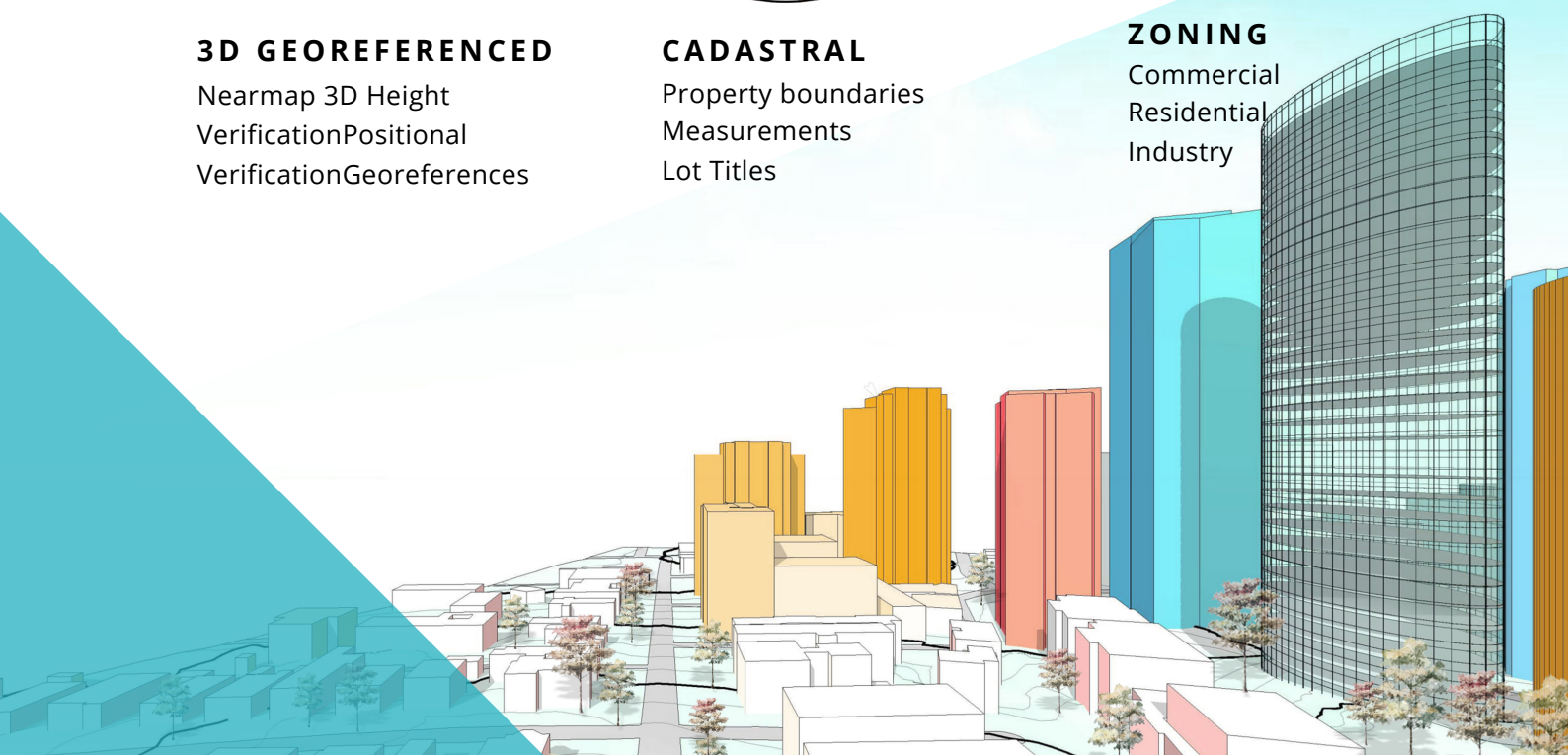

NEARMAP 3D INTEGRATION

ADVANTAGES:

- **Latest Imagery and Data**
- **Nearmap 2D:** clear, high-resolution orthographic imagery for building identification and footprint extraction
- **Nearmap 3D:** Multi-level building structure identification and high-resolution building height measurements

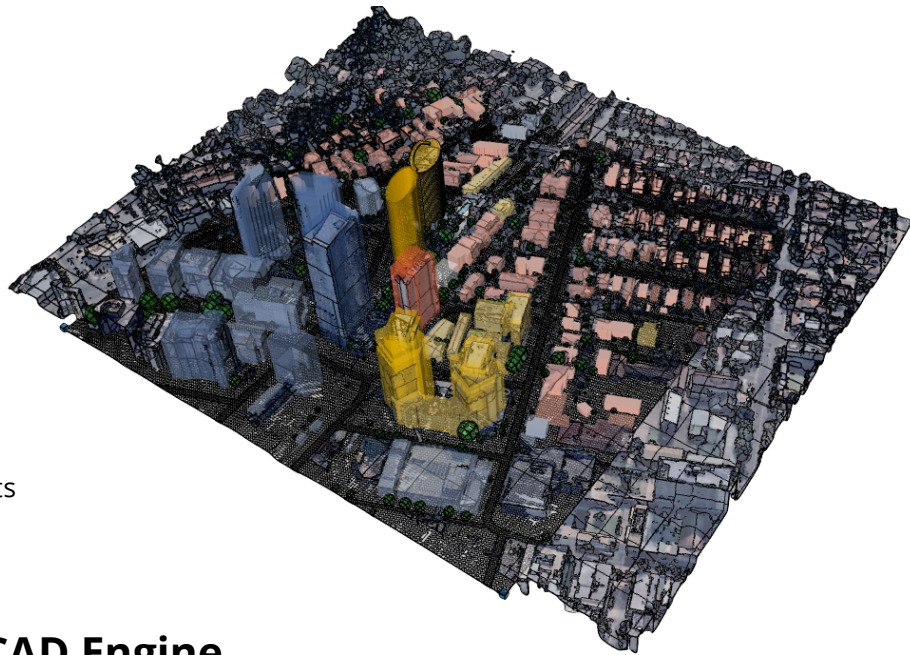

Context Map 3D Mesh-to-CAD Engine

Parametrisation of building structure and building / terrain optimisation for cross-platform CAD models

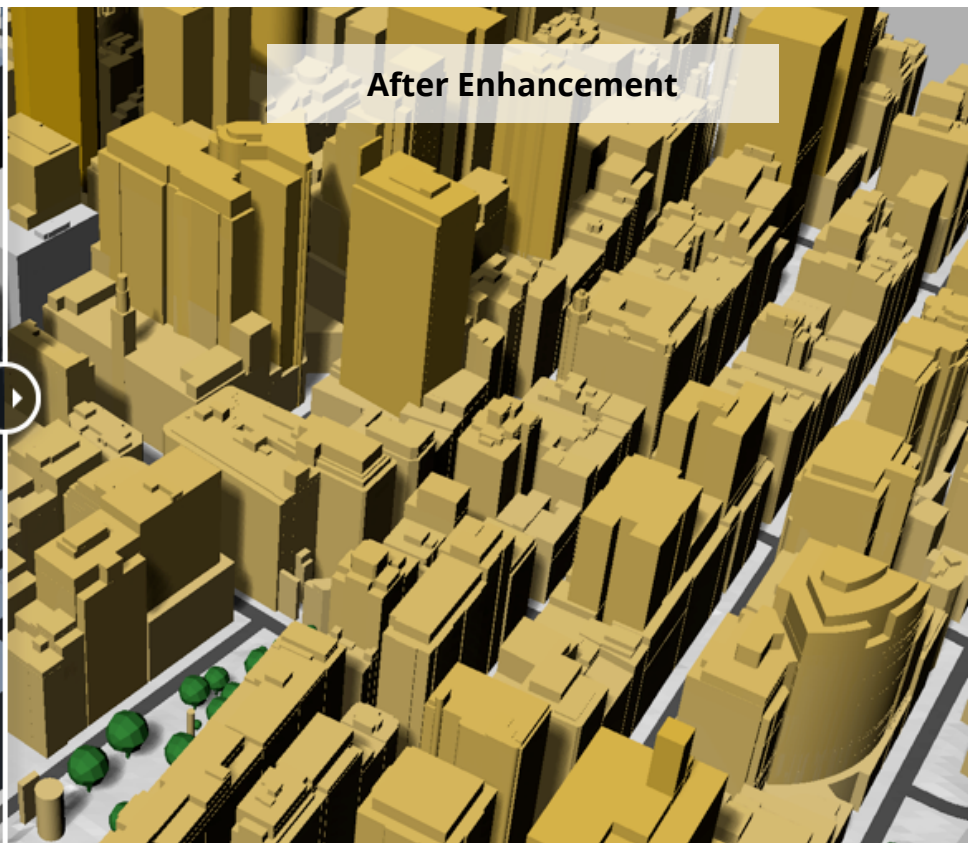
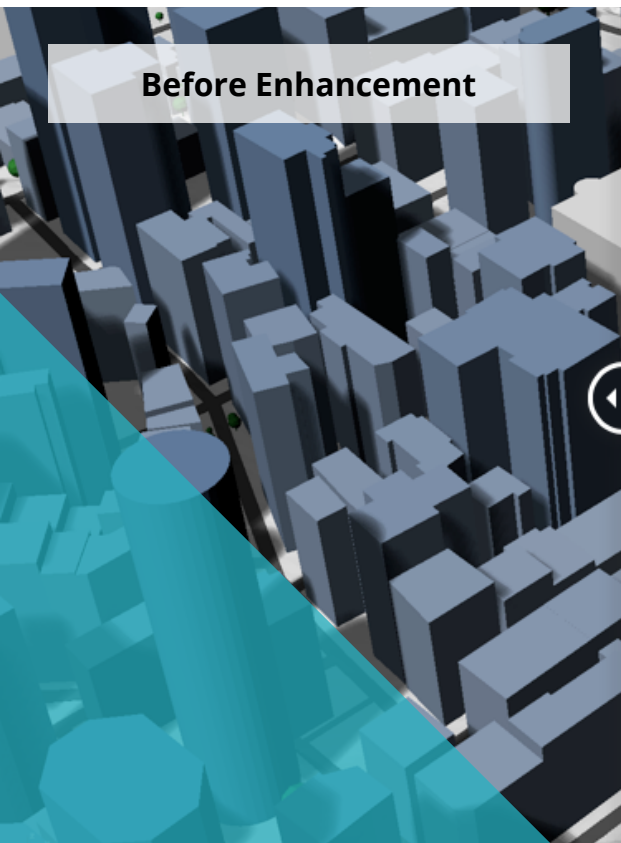

NATIVE CAD

AUTOCAD

VECTORWORKS

RHINO 3D

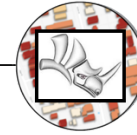
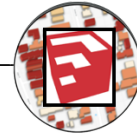
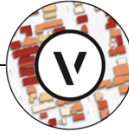

REVIT

ARCHICAD

SKETCHUP

Optimised, native editable CAD elements. **Samples available now!**

Revit Sample

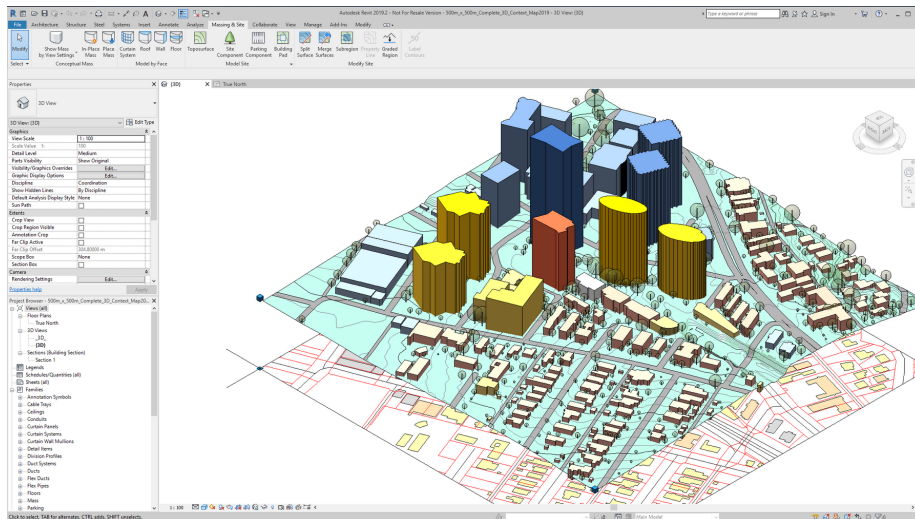

ArchiCAD Sample

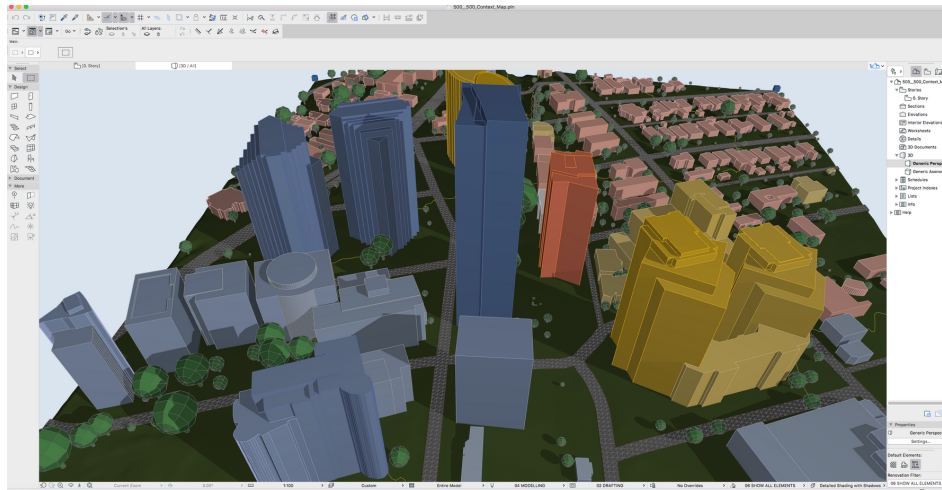

APPLICATIONS



MODIFY AND INTEGRATE YOUR OWN SITE DESIGN EASILY



FIND OUT MORE DETAILS ABOUT YOUR SITE BEFORE VIEWING



JUMPSTART YOUR PROJECT DEVELOPMENT



TREE AND LANDSCAPE DATA



PRESENTABLE 3D IMAGE TO SHOW TO YOUR CLIENTS



DIRECT SUN POSITIONING

- ✓ Build a base model of your site in seconds rather than days
- ✓ Modify and integrate your own site design easily
- ✓ Find out more details of your site before surveying
- ✓ Jump start your project development
- ✓ Presentable 3D image to show your clients
- ✓ Tree and landscape data
- ✓ Direct sun positioning
- ✓ Available to you within 1 - 3 days

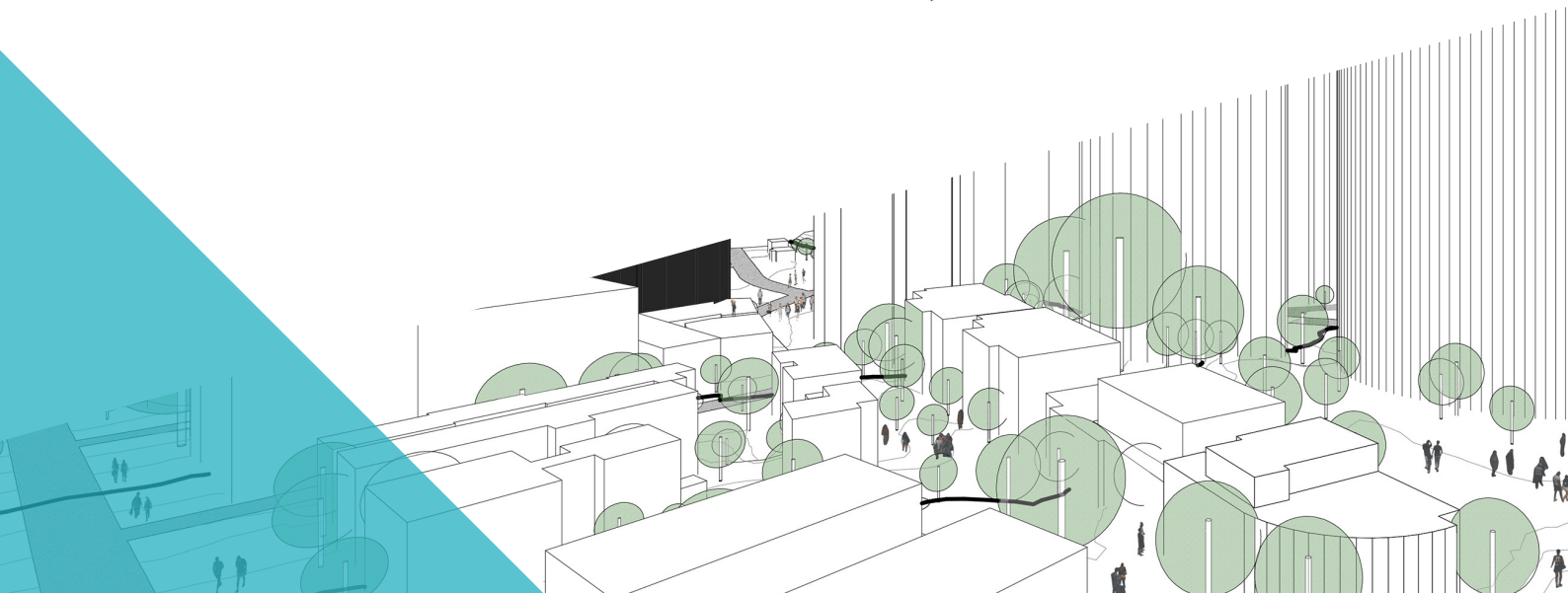
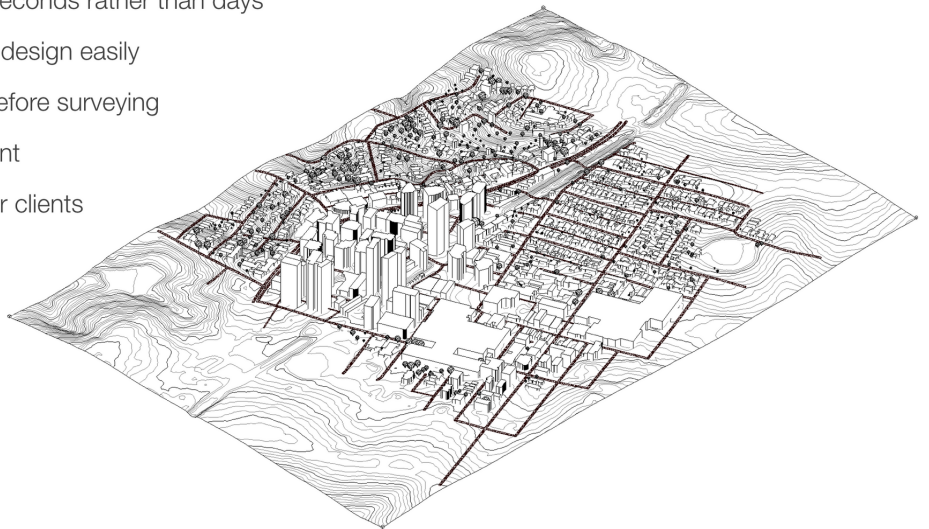

SITE ANALYTICS

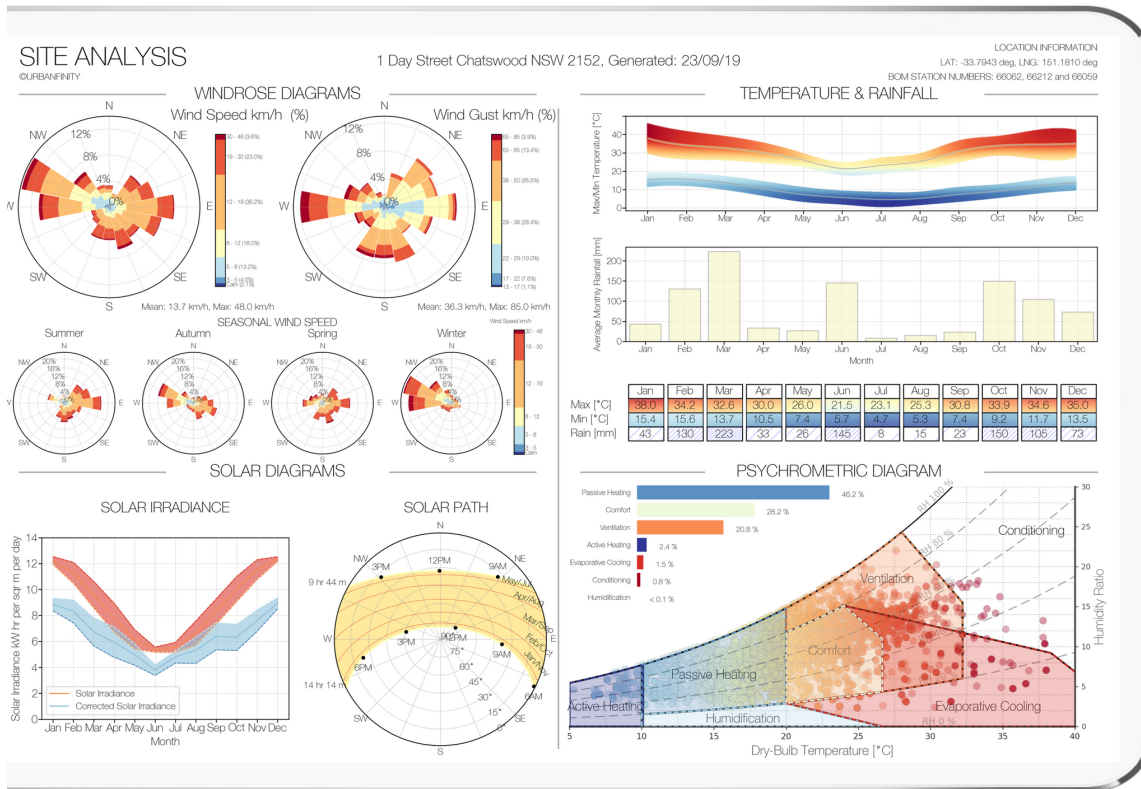

Gain insights of weather patterns across Australia

Site Analysis machine learning tech is based on more than 600 weather station across Australia and provides you with the most accurate weather analysis to date.

- Monitor wind patterns and seasonal variations
- Rainfall and temperature analysis using 15 years of historical data
- Psychrometric data to optimise the buildings energy efficiency
- Solar diagrams to identify the optimal building orientation
- Readily available in PNG or PDF format

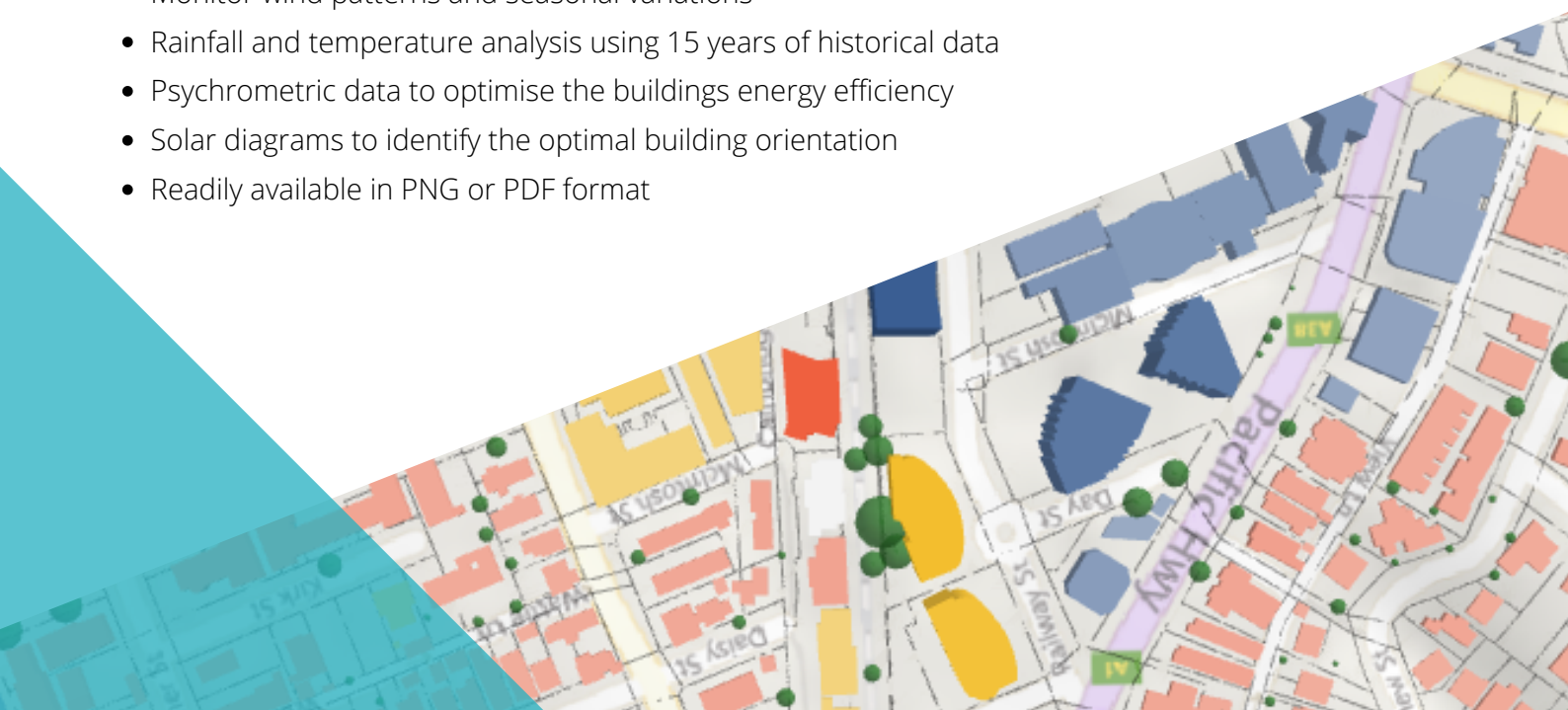

SITE PLANS

Gain Rapid Insight about your Site

Create instant visual reports and implement the optimal design that respond to site specific environmental and physical features.

- Built Environment Specifications
- Cadastral Measurements and Angles
- High Resolution Nearmap Imagery
- Solar Path
- Instant Download

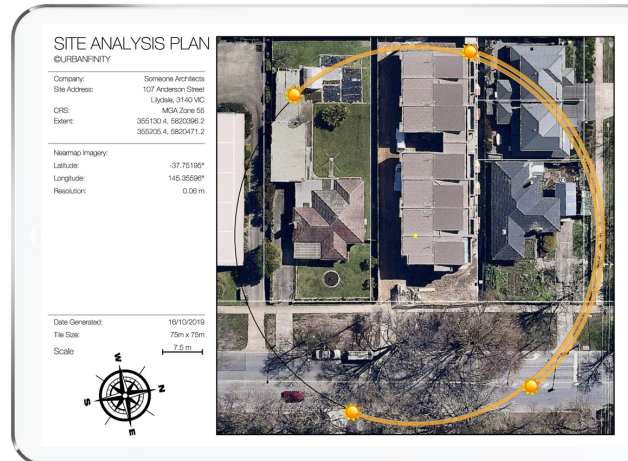
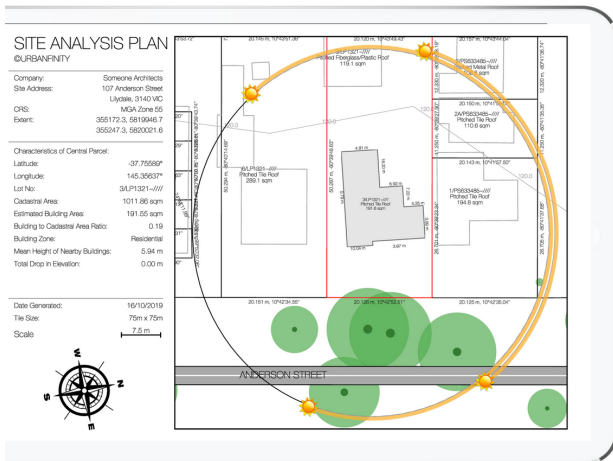
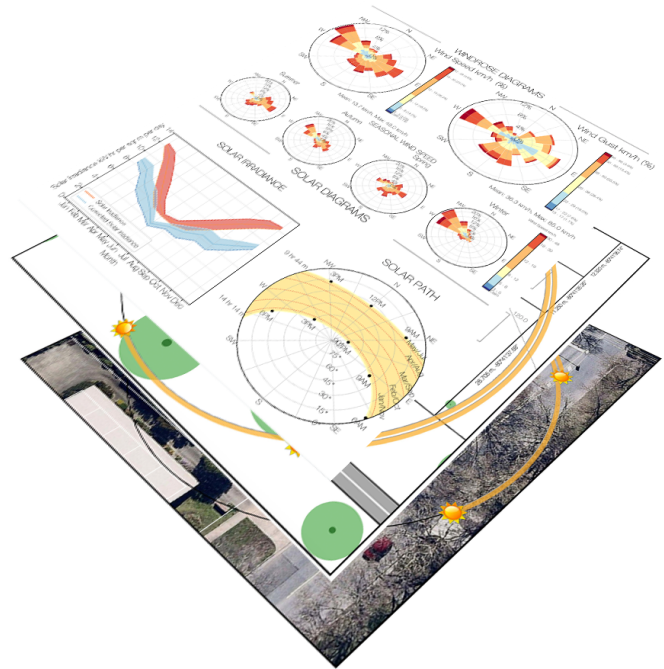

DESIGNED FOR

Architects: Context Models & Design Analysis

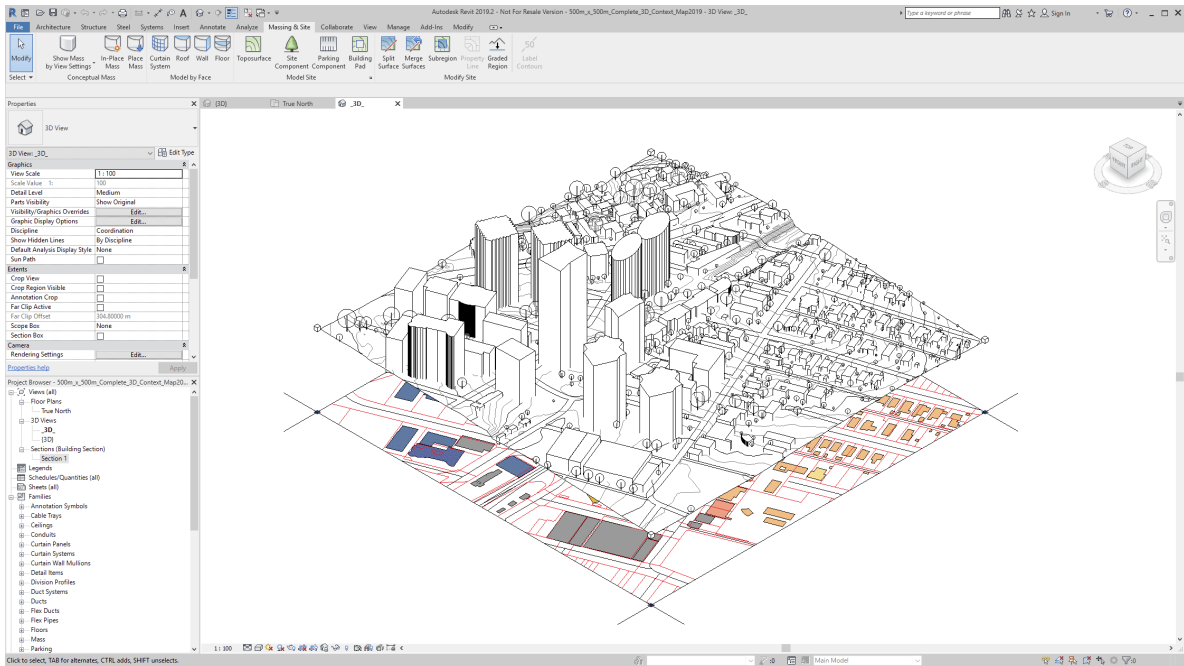

Urban Planning: Development & Optimisation

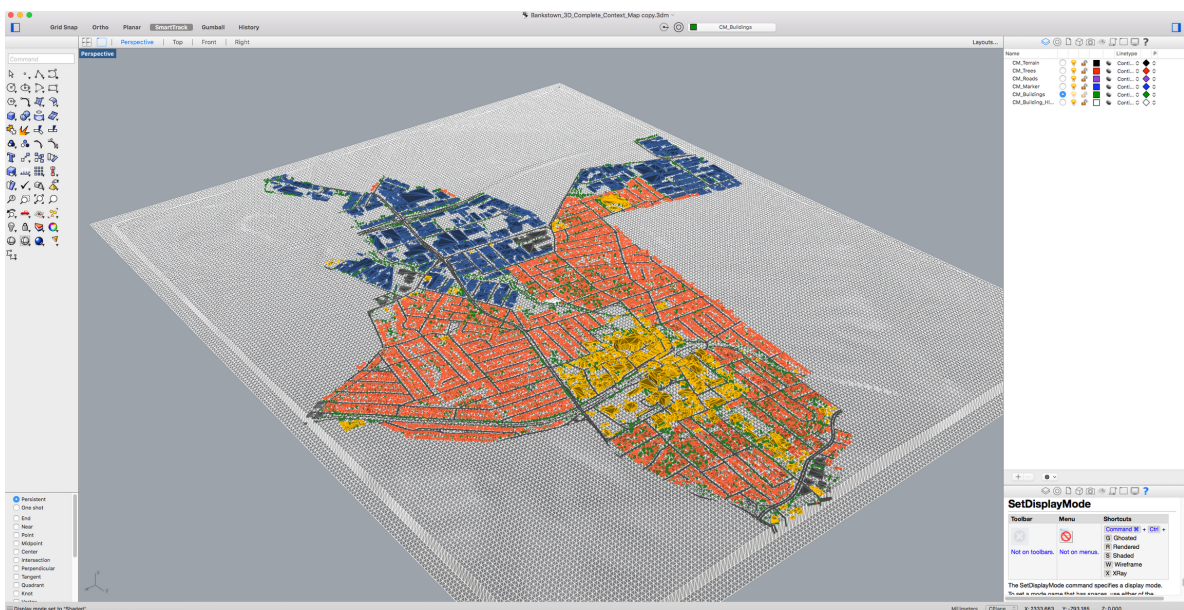

DESIGNED FOR

Site Survey Integration

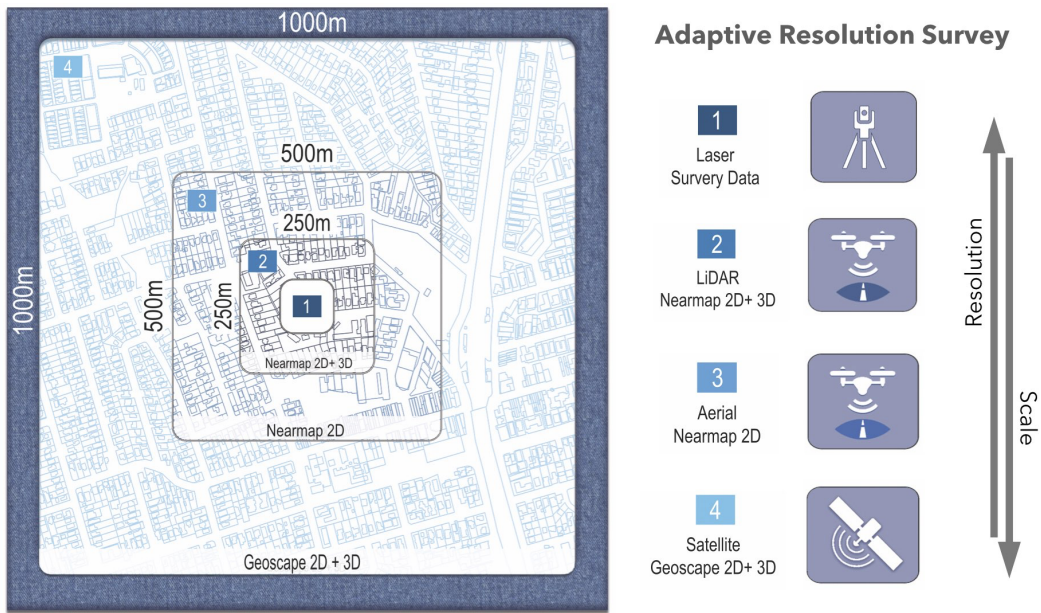

Town Planners: Interactive 3D PDF Report

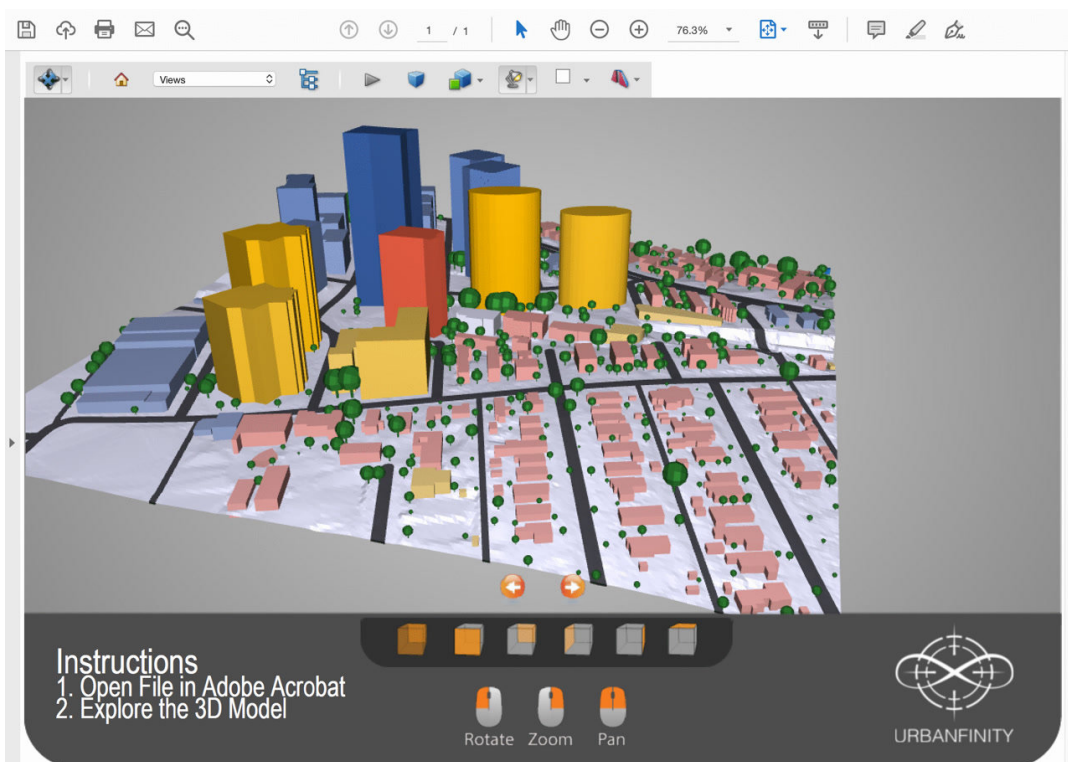

EXAMPLE PORTFOLIO

Southern CBD, Sydney

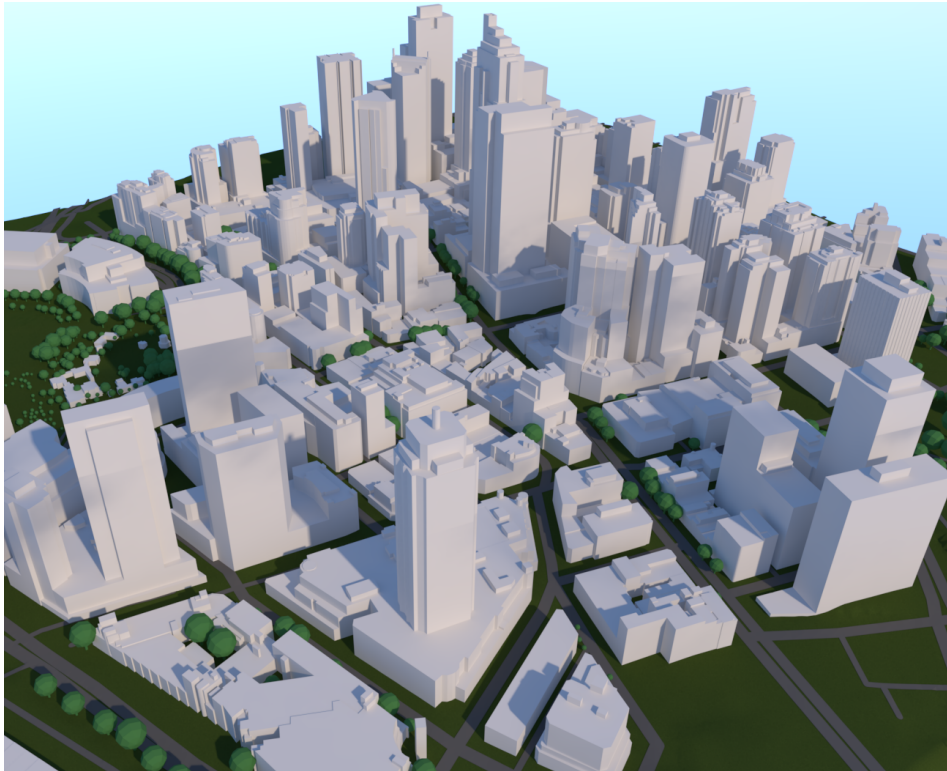

Surry Hills, Sydney



FEATURE SPECIFICATIONS

	3D	2D
Buildings	Enhanced Level of Detail	Zone Representation
	Height Visualisation	Building Position
	Zone Representation	Building Footprints
	Building Position	
Cadastre	Overlay	Lot Titles
		Lot Lengths
Vegetation	Native Tree Elements	Tree Position and Size
Zoning	Visual Colour based on Building Zone	Visual Colour based on Building Zone
Topography	Road Representation	Street Names
	Native Terrain Element	Road Cadastre
	Terrain Contours	Terrain Contours
		Hydrolines and Hydro Polygons



DATA SPECIFICATIONS

Accuracy	3D Nearmap	2D Nearmap	Terrain
Ground sampling distance (GSD)	15cm	5.8-7.5cm (or better)	1m (where available), otherwise 5m
Absolute horizontal accuracy	28cm RMSE _{x/y}	25.3-61.7cm RMSE _{x/y} 11.5-15cm within one photo	45cm
Absolute vertical accuracy	40cm RMSE _z		15cm
Georeference	GDA94/UTM; other possible on request		

Cad Format Availability		
	3D	2D
Archicad	.pln	.pln
	.3dm	.dxf
	.skp	
Revit	.rvt	.rvt
	.skp	.dxf
Autocad	.dwg	.dwg
		.dxf
Vectorworks	.vwx	.vwx
	.skp	.dxf
	.ply	

Context Maps are derived from multiple data sources with location dependent availability and accuracy. Urbanfinity applies detailed quality verification and completeness tests to achieve the best possible Context Map model for your site. However, Urbanfinity does not warrant a 100% feature completeness and multiple factors can contribute to the effective final accuracy of the Context Map model features.

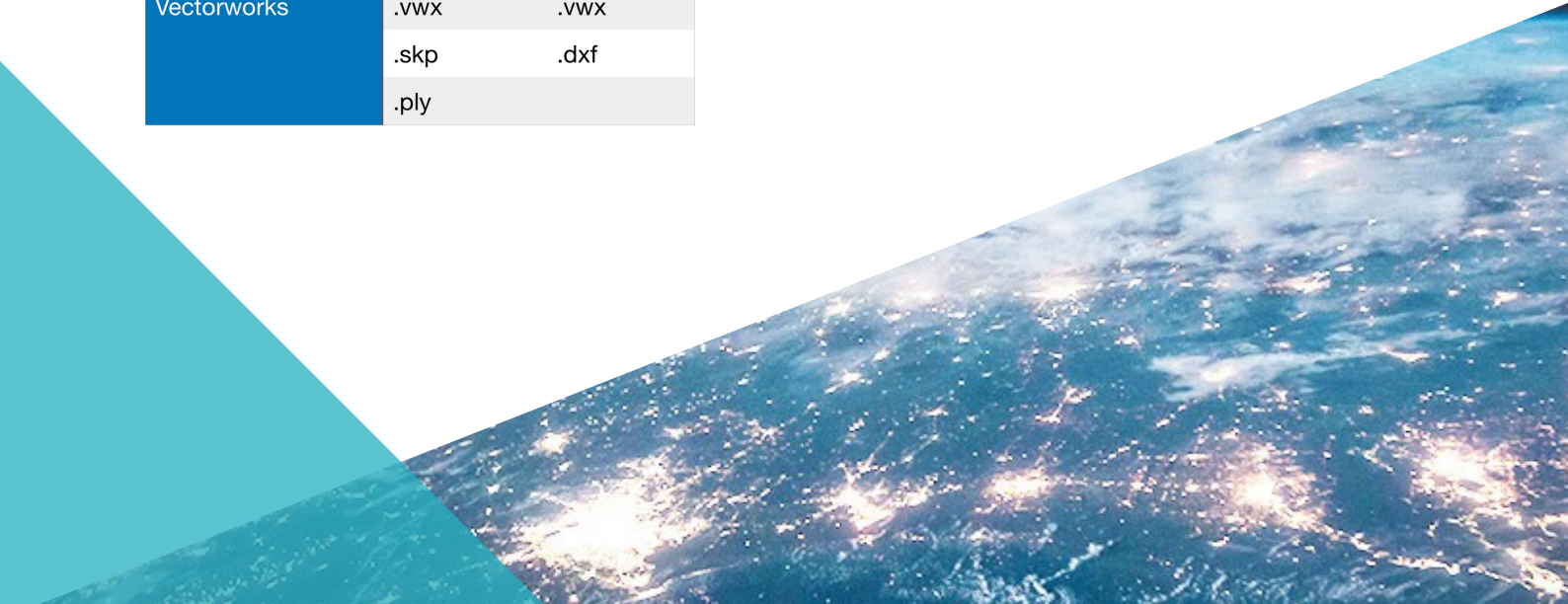

DISCLAIMER

Urbanfinity believes this publication to be correct at the time of printing and does not accept responsibility for any consequences arising from the use of information herein. Although the data used for generating the Context Maps and 3D Models by Urbanfinity have been produced and processed from sources believed to be reliable, no warranty, expressed or implied, is made regarding accuracy, adequacy, completeness, legality, reliability or usefulness of any information. Readers and businesses should rely on their own skill and judgement to apply information to their project. You expressly agree that your use of, or inability to use, the service is at your sole risk. In no case shall Urbanfinity, our directors, officers, employees, affiliates, agents, contractors, interns, suppliers, service providers or licensors be liable for any injury, loss, claim, or any direct, indirect, incidental, punitive, special, or consequential damages of any kind, including, without limitation lost profits, lost revenue, lost savings, loss of data, replacement costs, or any similar damages, whether based in contract, tort (including negligence), strict liability or otherwise, arising from your use of any of the service or any products procured using the service, or for any other claim related in any way to your use of the service or any product, including, but not limited to, any errors or omissions in any content, or any loss or damage of any kind incurred as a result of the use of the service or any content (or product) posted, transmitted, or otherwise made available via the service, even if advised of their possibility.

This work is copyright. Apart from any use as permitted under the Copyright Act 1968, no part may be reproduced by any process without prior written permission of Urbanfinity Pty Ltd. Source data for building heights and vegetation is derived from Nearmap 3D. Nearmap license and terms can be found on their product agreement page (<https://www.nearmap.com/au/en/legal/terms-of-use>) Urbanfinity Pty Ltd is an Approved Reseller by Nearmap. Third parties are only permitted to use the Data within their own business in a way that does not make any Urbanfinity/Nearmap data (or any output, product or service derived from use of it) available to another third party.



CONTACT US

START WORKING WITH REAL-WORLD
INSIGHT OF YOUR SITE TODAY.



1300 429 205



service@urbanfinity.com.au



www.urbanfinity.com.au

or order directly online:

<https://contextmap.com.au>

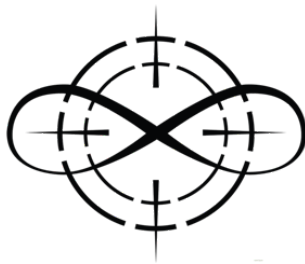

URBANFINITY
BECAUSE INNOVATION
HAS NO LIMITS.

Suite 5/04
161 Gloucester Street
The Rocks
New South Wales
2000

1300 429 205
www.urbanfinity.com.au

W E L C O M E T O
URBANFINITY